

# Pipe Drivers NDG /AND

## Type NDG pipe driver

### Clamping tools for tooling between center pins

The entire outside surface of a tubular work piece can be tooled with one single clamping and high torque transmission.

By means of a pipe driver, large clamping areas can be covered.

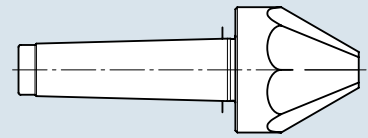

### Clamping principle

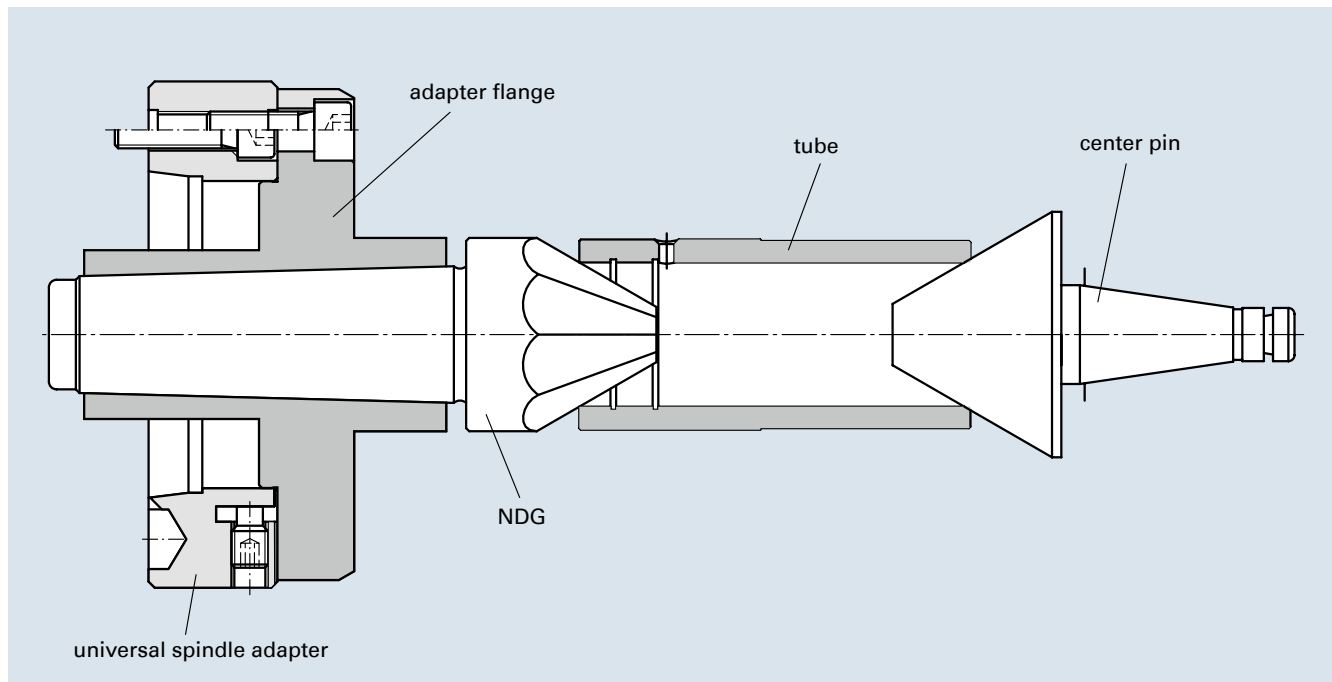

### NEIDLEIN pipe driver NDG and AND ensure:

- high torque transmission, thus achieving a high rate of metal removing
- extended service life of driving chisels
- large clamping area of tubular work pieces 2-155 mm bore-diameter
- finishing of outer surface by clamping → saving of time
- easy handling



**Technical data – type NDG pipe driver**

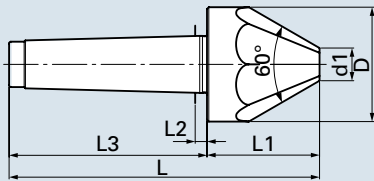

cat. no.	type	morse taper	D	d1	L	L1	L2	L3	a	chisel pcs	for bore-Ø	
											from	to
<b>75001</b>	<b>NDG 0/15</b>	2	18	0	100	32	4	68	60°	6	2	17
<b>75002</b>	<b>NDG 0/30</b>	3	31	0	135	50	5	85	60°	6	2	30
<b>75003</b>	<b>NDG 10/40</b>	3	45	8	145	60	5	85	60°	6	9	43
<b>75004</b>	<b>NDG 20/60</b>	3	63	18	147	62	5	85	60°	8	19	60
<b>75005</b>	<b>NDG 10/40</b>	4	45	8	168	60	6	108	60°	6	9	43
<b>75006</b>	<b>NDG 20/60</b>	4	63	18	170	62	6	108	60°	8	19	60

**Technical data – type NDG drive cone exchangeable**

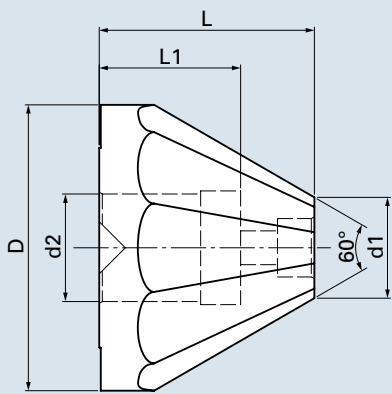

cat. no.	type	D	d1	d2	L	L1	a	chisel pcs	for bore-Ø	
									from	to
<b>75101</b>	<b>NDG 35/90</b>	93	32.8	35	70	46	60°	10	33	90
<b>75102</b>	<b>NDG 90/155</b>	158	88	35	75	46	60°	10	88	155

**Technical data – type AND arbor**

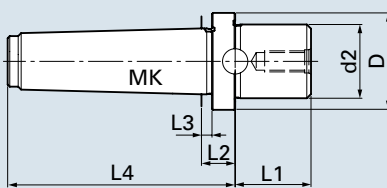

cat. no.	type	morse taper	D	d2	L1	L2	L3	L4
<b>75201</b>	<b>AND 35/4</b>	4	46	35	M10	36	16	108
<b>75202</b>	<b>AND 35/5</b>	5	44.5	35	M10	36	16	130
<b>75203</b>	<b>AND 35/6</b>	6	64	35	M10	36	16	144