

DIMAC T-Nuts

Dimac manufacture a wide range of standard T-Nuts in addition to custom sizes for chucks not shown below.

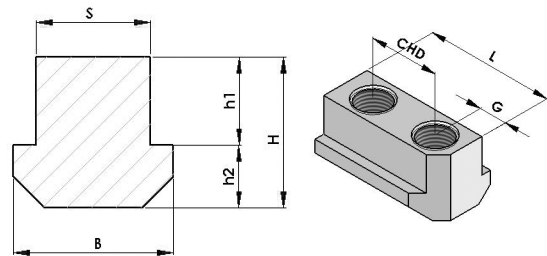

T-Nuts for KITAGAWA chucks

Part No.	H	h1	h2	B	L	G	CHD	S	Cap Screw	ALT. No	Chuck Models
TN0815B04	13.5	9	4.5	11.5	24.5	4.5	15	8	M6	KTNB-04	B-04, BT-04
TN1014B204/5	15	9.5	5.5	15	26	6	14	10	M8	KTNB-205	B-204, BT-204, B-205, BT-205
TN1014N04	18	12.5	5.5	15	28	7	14	10	M8	KTNN-04	N-04, NT-04, NL-04, AS-04, AT-04, NRC-04, HJ-4
TN1018B05	15.5	10	5.5	14	30	6	18	10	M8	KTNB-05	B-05, BT-05, HOB-05, HOBTF05
TN1019N05	18	12.5	5.5	15	32	6	19	10	M8	KTNN-05	N-05, NT-05, HJ-5
TN1220BB206	18.5	11	7.5	17	36.5	8.25	20	12	M10	KTNBB-206	BB-206
TN1220B206	18.5	11	7.5	17.5	36	8.25	20	12	M10	KTNB-206	B-206, BT-206, HOH-206, BL-206, BLT-206, BS-306, HW-08
TN1220B/N06	22.5	15	7.5	17.5	36.5	7.5	20	12	M10	KTNB-06	B-06, BT-06, HOH-06K, N-06, NT-06, HJ-6, NL-06, NLT-06, AS-06, AT-06, NRC-06
TN1425B208	20.5	12	8.5	20.5	46.5	10.5	25	14	M12	KTNB-208	B-208, BB-208, BT-208, HPH-208, BL-208, BLT-208, BS-308
TN1425B/N08	25.5	16	9.5	20.5	48	11	25	14	M12	KTNB-08	B-08, BT-08, HOH-08K, N-08, NT-08, HJ-08, NL-08, NLT-08, AS-08, AT-08, NRC-08
TN1630B210	21.5	13	8.5	22.5	51	11	30	16	M12	KTNB-210	B-210, BB-210, BT-210, BL-210, BLT-210, BS-310
TN1630B/N10	25.5	16	9.5	22.5	55	11	30	16	M12	KTNB-10	B-10, BT-10, HOH-10K, N-10, NT-10, NLT-10, NL-10, HJ-10, AS-10, AT-10, NRC-10, HW-10, HW-12
TN1830B/N12	33.5	20	13.5	26.5	56.5	11.5	30	18	M14	KTNB-12	B-12, BT-12, N-12, NT-12, NL-12, NLT-12
TN2130B212	27.75	16.25	11.5	29.5	55.5	12	30	21	M16	KTNB-212	B-212, BT-212, BL-212, BLT-212
TN2130BB212	22.75	11.25	11.5	29.5	56.25	12	30	21	M16	KTNBB-212	BB-212
TN2243B15	45.5	29	16.5	33.5	80	17	43	22	M20	KTNB-15	B-15, BT-15, B-18, HOB-15, HOBTF-15, HPH-15, HO-15, HLA8-18, HJA11-15
TN2543B215	39	20	19	35	80	17	43	25	M20	KTNB-215	B-215
TN2550B21H	45	26	19	37.5	90	20	50	25	M20	KTNB-21H	B-21, B-24, (hard jaw only)
TN2560B21S	45	26	19	37.5	90	20	60	25	M20	KTNB-21S	B-21, B-24, (soft jaw only)

T-Nuts for AUTOBLOK chucks

Part No.	H	h1	h2	B	L	G	CHD	S	Cap Screw	ALT. No	Chuck Models
TN1416AUT	18.5	12	6.5	17	32	8	16.5	14	M10	73061650	AN165, AL165, AP165, NT165, BH165, BH-FC165, RC165, PB165, BB165, HB165, BB175, HYN175, HYL175
TN1723AUT	20.5	13	7.5	19	43	10	23	17	M12	73062150	AN210, AL210, NT210, BH210, BH-FC210, BB210, RC210, PB210, PBI210, HB210, HYN210, HYL210, HYL226
TN1722AUTGHD200	22	13.4	8.6	22.5	42	10	22	17	M12	-	GHD200
TN2130AUT	26.5	16.5	10	25	56	13	30	21	M16	73063050	AN250, AL250, BH250, BH-FC250, BB250, RC250, PB250, PBI250, HB250, HYN250, HYL250
TN2130AUTGHD315	25	14	11	29	54.5	12	30	21	M16	-	GHD315
TN2100AUT	25	14	11	29	24	12	0	21	M16	12063000	RC400
TN2538AUT	33	18.5	14.5	31	70	16	38	25.5	M20	73065030	AP400, NT400, RC500
TN2500AUT	34	19	15	35	30	15	0	25.5	M20	12065020	CL250, CL315, AN400, AL400, BH400, BH500, BH630, BH800
TN25/2800AUT	34	19	15	36	30	15	0	25.5	M20	12065082	HYN500, HYN630, HYL500, HYL630

If you do not see your chuck listed in the tables, or you require a Stepped T-Nut which allows the use of Jaws from another chuck, then please contact Dimac for more information.

Stepped T-Nuts

Part No.	Description
TN21-1830B212	TNut Set to convert from B12 Jaws to B-212 Chuck

